

186



Rubinetti portagomma Ball bib-cocks



Per impianti idrotermosanitari, adatte al consumo di acqua potabile. Installazione in impianti di media pressione di riscaldamento industriale, civile, impianti pneumatici, per fluidi non aggressivi.

For plumbing-heating systems and drinking water consumption. Installation in medium pressure industrial and civil heating systems, pneumatic systems and for non-aggressive fluids.

PN25



**NICHELATE
ESTERNAMENTE**
EXTERNALLY
NICKEL-PLATED

Pressione di esercizio: 25 bar
Temperatura di esercizio: -20°C +130°C (gelo escluso)
Filetti cilindrici secondo norma ISO 228-1
Tenuta sull'asta: asta assemblata dall'interno con 2 OR in EPDM PEROX
Tenuta sulla sfera con 2 sedi in PTFE

Working pressure: 25 bar
Working temperature: -20°C +130°C (no frost)
Cylindrical threads according to ISO 228-1
Seal on the stem: stem assembled from inside with 2 EPDM PEROX OR
Seal on the ball with 2 PTFE gaskets

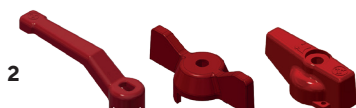
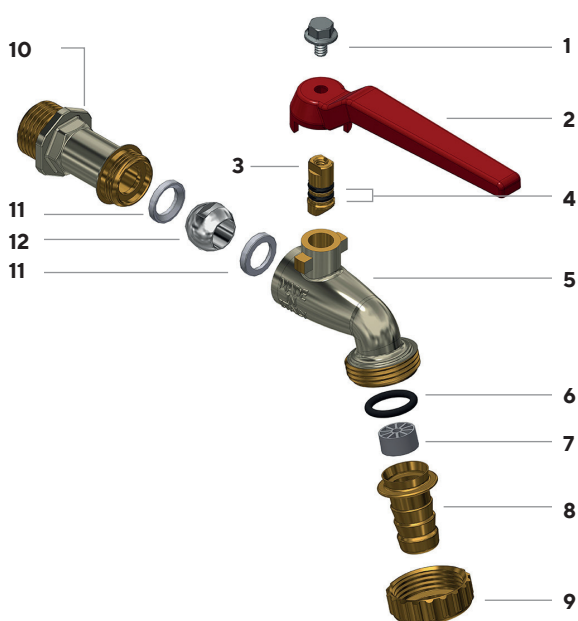

- 1 Vite in acciaio AISI 430
- 2 Leve disponibili: vedi tabelle seguenti
- 3 Asta in CW614N EN 12164
- 4 O-ring in EPDM PEROX
- 5 Corpo rubinetto cigno CW617N UNI EN 12165 nichelato sulla superficie esterna
- 6 O-ring in EPDM PEROX
- 7 Rompigetto in ABS
- 8 Portagomma in CW617N UNI EN 12165
- 9 Ghiera in CW617N UNI EN 12165
- 10 Manicotto rubinetto curvo CW617N UNI EN 12165 nichelato sulla superficie esterna
- 11 Sede PTFE
- 12 Sfera cromata in CW617N UNI EN 12165



- 1 AISI 430 steel screw
- 2 Available levers: see following tables
- 3 CW614N UNI EN 12164 stem
- 4 EPDM PEROX O-ring
- 5 CW617N UNI EN 12165 body valve, nickel-plated on the external surface
- 6 EPDM PEROX O-ring
- 7 ABS diffuser head
- 8 CW617N UNI EN 12165 hose connection
- 9 CW617N UNI EN 12165 nut
- 10 CW617N UNI EN 12165 end adaptor, nickel-plated on the external surface
- 11 PTFE gasket
- 12 CW617N UNI EN 12165 chrome-plated ball

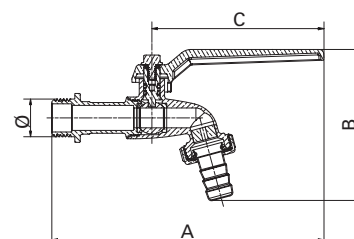

Con leva in alluminio
With aluminium lever

ACQUA POTABILE
 DRINKING WATER





Attacchi Connections	Codice prodotto Product code		PN	A ±1mm	B mm	C mm	Conf. num. pezzi Pack. num. pieces
							
1/2"	186D1/2G5R	186D1/2G5B	25	150,5	83,5	95	5/60
3/4"	186E3/4G5R	186E3/4G5B	25	157	102	95	3/36
1"	186F001G5R	186F001G5B	25	167,5	115	95	12

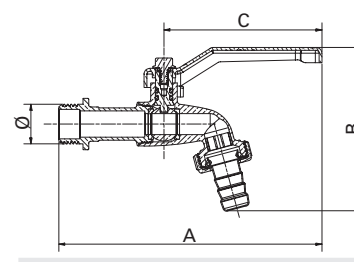

Con leva in acciaio imbutita
With drawn steel lever

ACQUA POTABILE
 DRINKING WATER



Attacchi Connections	Codice prodotto Product code		PN	A ±1mm	B mm	C mm	Conf. num. pezzi Pack. num. pieces
							
1/2"	186D1/2G1R	186D1/2G1B	25	138,5	85	83	5/60
3/4"	186E3/4G1R	186E3/4G1B	25	145	103,5	83	3/36
1"	186F001G1R	186F001G1B	25	155,5	116	83	12

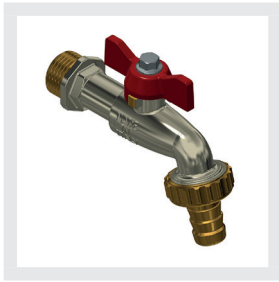

Farfalla in alluminio "T" With aluminium "T" handle

ACQUA POTABILE
DRINKING WATER

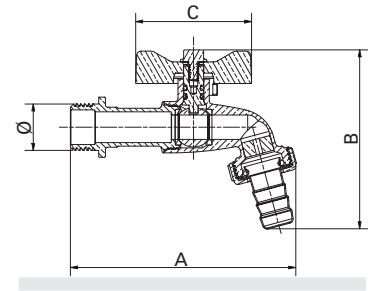

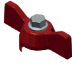
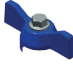

Attacchi Connections	Codice prodotto Product code		PN	A ±1mm	B mm	C mm	Conf. num. pezzi Pack. num. pieces
							
1/2"	186D1/2G6R	186D1/2G6B	25	101	80,5	52	5/60
3/4"	186E3/4G6R	186E3/4G6B	25	122	99,5	52	3/36
1"	186F001G6R	186F001G6B	25	142	111,5	52	12

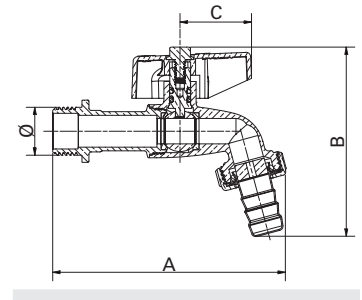

Con manopola in alluminio With aluminium knob

ACQUA POTABILE
DRINKING WATER



Attacchi Connections	Codice prodotto Product code		PN	A ±1mm	B mm	C mm	Conf. num. pezzi Pack. num. pieces
							
1/2"	186D1/2G2R	186D1/2G2B	25	101	82,5	31,5	5/60
3/4"	186E3/4G2R	186E3/4G2B	25	122	101,5	31,5	3/36
1"	186F001G2R	186F001G2B	25	142	113,5	31,5	12