

382



PN5

Valvole a sfera maschio/femmina per gas Male/female gas ball valves

MADE IN ITALY



**NICHELATE
ESTERNAMENTE**
EXTERNALLY
NICKEL-PLATED

PASSAGGIO TOTALE FULL BORE

Installazione in impianti di distribuzione del gas della 1^a - 2^a - 3^a famiglia.

Suitable for 1st - 2nd - 3rd family gas distribution systems.

Pressione di esercizio: 5 bar
Temperatura di esercizio: -20°C + 60°C (gelo escluso)
Filetti cilindrici secondo norma ISO 228-1 (corpo)
Filetto conico secondo norma EN 10226 - ISO7/1 - (manicotto)
Tenuta sull'asta:
- da 1/2" a 2" asta assemblata dall'interno con 1 OR in VITON, premistoppa in PTFE e regolabile con ghiera.
- 1/4" e 3/8" asta assemblata dall'esterno con premistoppa in PTFE e ghiera regolabile.
Tenuta sulla sfera con 2 sedi in PTFE
Passaggio totale

Working pressure: 5 bar
Working temperature: -20°C + 60°C (no frost)
Cylindrical threads according to ISO 228-1 (body)
Conical threads according to EN 10226 - ISO7/1 (end adaptor)
Seal on the stem:
- from 1/2" to 2" stem assembled from inside with 1 VITON OR, PTFE seal and adjustable packing gland.
- 1/4" and 3/8" stem assembled from outside with PTFE gasket and adjustable packing gland.
Seal on the ball with 2 PTFE gaskets
Full bore

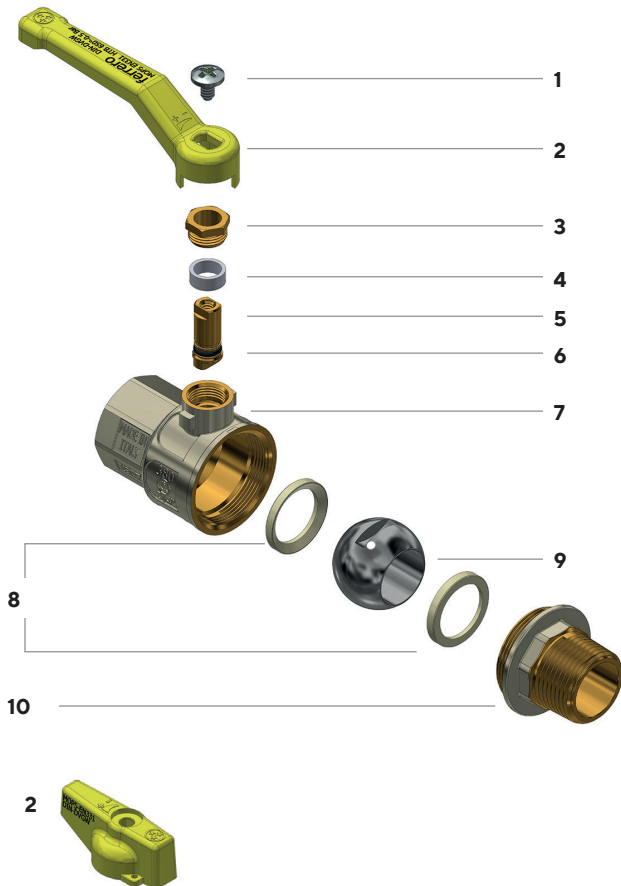

- 1 Vite in acciaio AISI 430
- 2 Con leva in acciaio o manopola in alluminio
- 3 Ghiera in CW614N EN 12164
- 4 Anello premistoppa in PTFE
- 5 Asta in CW614N EN 12164
- 6 O-ring in FKM
- 7 Corpo valvola CW617N UNI EN 12165 nichelato sulla superficie esterna
- 8 Sede in PTFE
- 9 Sfera in CW617N UNI EN 12165 cromata
- 10 Manicotto in CW617N EN 12165 nichelato sulla superficie esterna

- 1 AISI 430 steel screw
- 2 With drawn steel lever or aluminium knob
- 3 CW614N UNI EN 12164 packing gland
- 4 PTFE ring seal
- 5 CW614N UNI EN 12164 stem
- 6 FKM O-ring
- 7 CW617N UNI EN 12165 body valve, nickel-plated on the external surface
- 8 PTFE gasket
- 9 CW617N UNI EN 12165 chrome-plated ball
- 10 CW617N UNI EN 12165 end adaptor, nickel-plated on the external surface



Con leva in acciaio imbutita
With drawn steel lever

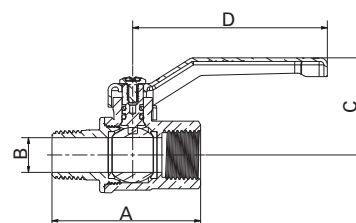

Attacchi Connections	Codice prodotto Product code	PN	A ±1mm	B mm	C mm	D mm	Conf. num. pezzi Pack. num. pieces
1/4"	382B14G1G	5	48	11	44	83	12/144
3/8"	382C38G1G	5	48	11	44	83	12/144
1/2"	382D12G1G	5	58	15	45	83	10/120
3/4"	382E34G1G	5	66	20	48	83	6/72
1"	382F001G1G	5	80	25	68	90	4/48
1" 1/4	382G114G1G	5	97	32	73	90	10
1" 1/2	382H112G1G	5	107	40	82	160	10
2"	382I002G1G	5	131	50	90	160	10

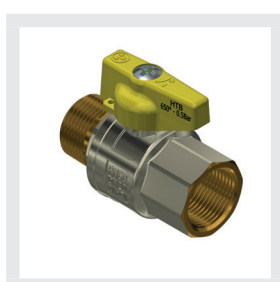

Con manopola in alluminio
With aluminium knob

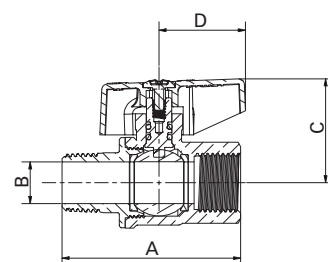

Attacchi Connections	Codice prodotto Product code	PN	A ±1mm	B mm	C mm	D mm	Conf. num. pezzi Pack. num. pieces
1/4"	382B14G2G	5	48	11	34	31,5	12/144
3/8"	382C38G2G	5	48	11	34	31,5	12/144
1/2"	382D12G2G	5	58	15	40	31,5	10/120
3/4"	382E34G2G	5	66	20	43,5	31,5	6/72
1"	382F001G2G	5	80	25	54	42,5	4/48
1" 1/4	382G114G2G	5	97	32	68	42,5	10