

370



Valvole a sfera femmina/femmina Female/female ball valves

ACQUA POTABILE
DRINKING WATER

PASSAGGIO TOTALE*
FULL BORE*

Per impianti idrotermosanitari, adatte al consumo di acqua potabile. Installazione in impianti di media pressione di riscaldamento industriale, civile, impianti pneumatici, per fluidi non aggressivi.

For plumbing-heating systems and drinking water consumption. Installation in medium pressure industrial and civil heating systems, pneumatic systems and for non-aggressive fluids.

PN25

MADE IN ITALY



NICHELATE
ESTERNAMENTE
EXTERNALLY
NICKEL-PLATED

Pressione di esercizio: 25 bar

Temperatura di esercizio: -20°C +130°C
(gelo escluso)

Filetti cilindrici secondo norma ISO 228-1

Tenuta sull'asta: asta assemblata dall'interno con 2 OR in EPDM PEROX

Tenuta sulla sfera con 2 sedi in PTFE

*Passaggio totale (solo valvole da 2" passaggio standard)

Working pressure: 25 bar

Working temperature: -20°C +130°C (no frost)

Cylindrical threads according to ISO 228-1

Seal on stem: stem assembled from inside with 2 EPDM PEROX OR

Seal on the ball with 2 PTFE gaskets

*Full bore (standard bore only 2" valves)

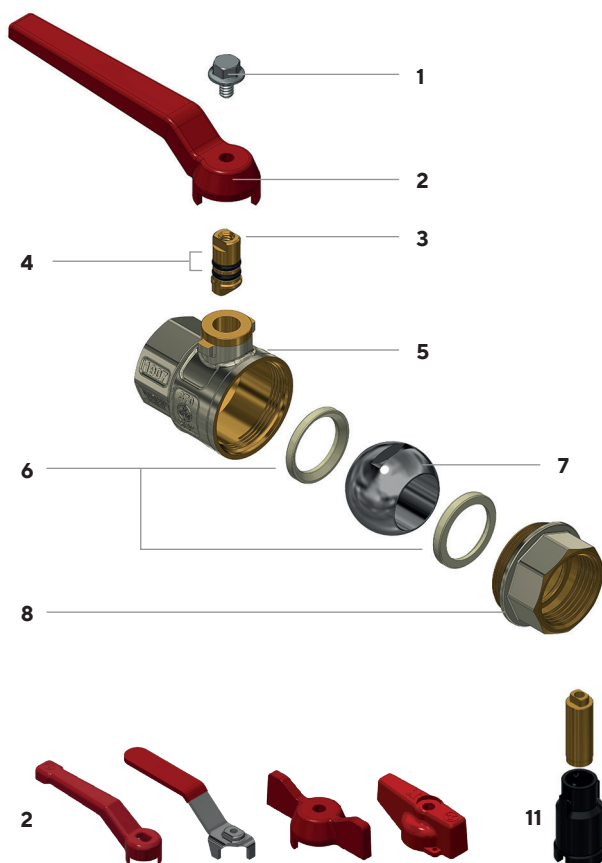

- 1 Vite in acciaio AISI 430 o in Fe-Zn/Bn a seconda dei modelli
- 2 Leve disponibili: vedi tabelle seguenti
- 3 Asta in CW614N UNI EN 12164
- 4 O-ring in EPDM PEROX
- 5 Corpo valvola CW617N UNI EN 12165 nichelato sulla superficie esterna
- 6 Sede in PTFE
- 7 Sfera in CW617N UNI EN 12165 cromata
- 8 Manicotto CW617N UNI EN 12165 nichelato sulla superficie esterna
- 9 Per versioni 1/2" e 3/4" canotto prolunga in plastica PA6 caricata 50% fibra di vetro, per versioni da 1" a 2" in CW617N UNI EN 12165 nichelato

- 1 AISI 430 steel or Fe-Zn/Bn screw, depending on model
- 2 Available levers: see following tables
- 3 CW614N UNI EN 12164 stem
- 4 EPDM PEROX O-ring
- 5 CW617N UNI EN 12165 body valve, nickel-plated on the external surface
- 6 PTFE gasket
- 7 CW617N UNI EN 12165 chrome-plated ball
- 8 CW617N UNI EN 12165 end adaptor, nickel-plated on the external surface
- 9 For 1/2" and 3/4" versions extension made of plastic sleeve PA6 loaded 50% glass fibre, for 1" to 2" versions of nickel-plated CW617N UNI EN 12165





Con leva in alluminio
With aluminium lever

ACQUA POTABILE
 DRINKING WATER

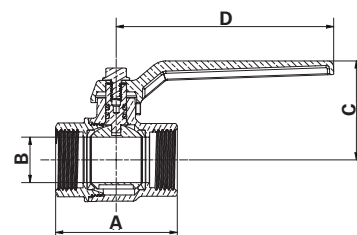

Attacchi Connections	Codice prodotto Product code	PN	A ±1mm	B mm	C mm	D mm	Conf. num. pezzi Pack. num. pieces	
3/8"	370C3/8G5R	370C3/8G5B	25	37,5	11	37,5	95	15/180
1/2"	370D1/2G5R	370D1/2G5B	25	44,5	15	40,5	95	12/144
3/4"	370E3/4G5R	370E3/4G5B	25	53	20	43,5	95	8/96
1"	370F001G5R	370F001G5B	25	66	25	59,5	115	4/48
1" 1/4	370G11/4G5R	370G11/4G5B	25	75	32	65	115	15
1" 1/2	370H11/2G5R	370H11/2G5B	25	84	40	77	165	10
2"	370I002G5R	370I002G5B	25	93	45	82	165	10



Con leva in acciaio imbutita
With drawn steel lever

ACQUA POTABILE
 DRINKING WATER

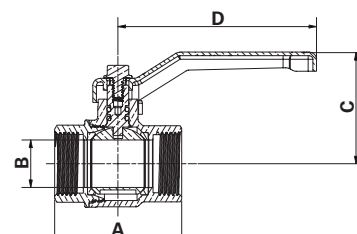



Attacchi Connections	Codice prodotto Product code	PN	A ±1mm	B mm	C mm	D mm	Conf. num. pezzi Pack. num. pieces	
3/8"	370C3/8G1R	370C3/8G1B	25	37,5	11	40	83	15/180
1/2"	370D1/2G1R	370D1/2G1B	25	44,5	15	42,5	83	12/144
3/4"	370E3/4G1R	370E3/4G1B	25	53	20	46	83	8/96
1"	370F001G1R	370F001G1B	25	66	25	67	90	4/48
1" 1/4	370G11/4G1R	370G11/4G1B	25	75	32	72,5	90	15
1" 1/2	370H11/2G1R	370H11/2G1B	25	84	40	79	160	10
2"	370I002G1R	370I002G1B	25	93	45	84	160	10

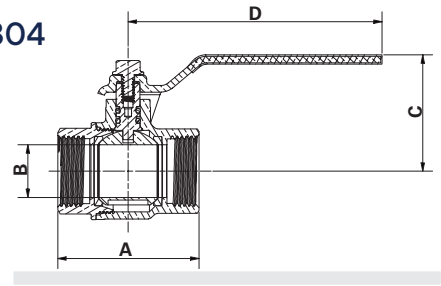

Con leva piatta in acciaio INOX AISI 304
 With AISI 304 stainless steel flat lever

ACQUA POTABILE
 DRINKING WATER





Attacchi Connections	Codice prodotto Product code		PN	A ±1mm	B mm	C mm	D mm	Conf. num. pezzi Pack. num. pieces
								
3/8"	370C3/8G4R	370C3/8G4B	25	37,5	11	37,5	95	12/144
1/2"	370D1/2G4R	370D1/2G4B	25	44,5	15	40,5	95	12/144
3/4"	370E3/4G4R	370E3/4G4B	25	53	20	43,5	95	8/96
1"	370F001G4R	370F001G4B	25	66	25	59,5	115	3/36
1" 1/4	370G11/4G4R	370G11/4G4B	25	75	32	65	115	15
1" 1/2	370H11/2G4R	370H11/2G4B	25	84	40	74,2	165	10
2"	370I002G4R	370I002G4B	25	93	45	79,5	165	10

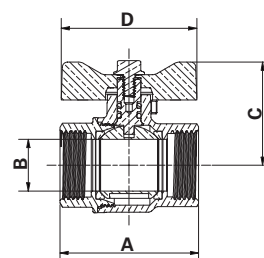

Con farfalla in alluminio "T"
With aluminium "T" handle

ACQUA POTABILE
 DRINKING WATER



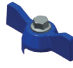

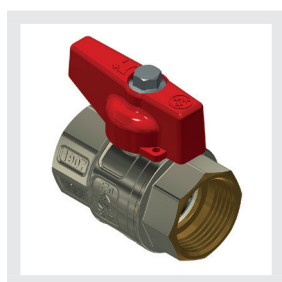
Attacchi Connections	Codice prodotto Product code		PN	A ±1mm	B mm	C mm	D mm	Conf. num. pezzi Pack. num. pieces
								
3/8"	370C3/8G6R	370C3/8G6B	25	37,5	11	34	52	12/144
1/2"	370D1/2G6R	370D1/2G6B	25	44,5	15	36,5	52	10/120
3/4"	370E3/4G6R	370E3/4G6B	25	53	20	39,5	52	8/96
1"	370F001G6R	370F001G6B	25	66	25	50,5	65	4/48
1" 1/4"	370G11/4G6R	370G11/4G6B	25	75	32	56	65	15

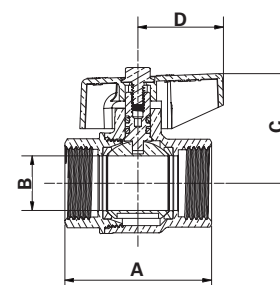

Con manopola in alluminio
With aluminium knob

ACQUA POTABILE
 DRINKING WATER



Attacchi Connections	Codice prodotto Product code		PN	A ±1mm	B mm	C mm	D mm	Conf. num. pezzi Pack. num. pieces
								
3/8"	370C3/8G2R	370C3/8G2B	25	37,5	11	34	31,5	15/180
1/2"	370D1/2G2R	370D1/2G2B	25	44,5	15	36,5	31,5	12/144
3/4"	370E3/4G2R	370E3/4G2B	25	53	20	39,5	31,5	10/120
1"	370F001G2R	370F001G2B	25	66	25	53	42,5	4/48
1" 1/4"	370G11/4G2R	370G11/4G2B	25	75	32	58,5	42,5	15





Con prolunga e leva in alluminio With extension stem and aluminium lever

Per versioni 1/2" e 3/4" canotto prolunga in plastica PA6 caricata 50% fibra di vetro, per versioni da 1" a 2" in CW617N UNI EN 12165 nichelato

For 1/2" and 3/4" versions extension made of plastic sleeve PA6 loaded 50% glass fibre, for 1" to 2" versions of nickel-plated CW617N UNI EN 12165

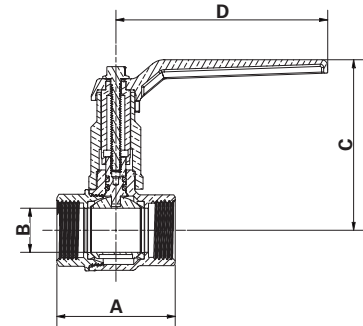
ACQUA POTABILE
DRINKING WATER



Attacchi Connections	Codice prodotto Product code		PN	A ±1mm	B mm	C mm	D mm	Conf. num. pezzi Pack. num. pieces
								
1/2"	370D1/2G5RFM	370D1/2G5BFM	25	44,5	15	73,7	95	40
3/4"	370E3/4G5RF	370E3/4G5BF	25	53	20	76,7	95	30
1"	370F001G5RF	370F001G5BF	25	66	25	99	115	30
1" 1/4	370G11/4G5RF	370G11/4G5BF	25	75	32	104	115	20
1" 1/2	370H11/2G5RF	370H11/2G5BF	25	84	40	129	165	16
2"	370I002G5RF	370I002G5BF	25	93	45	134	165	10





Con prolunga e leva in acciaio imbutita With extension stem and drawn steel lever

Per versioni 1/2" e 3/4" canotto prolunga in plastica PA6 caricata 50% fibra di vetro, per versioni da 1" a 2" in CW617N UNI EN 12165 nichelato

For 1/2" and 3/4" versions extension made of plastic sleeve PA6 loaded 50% glass fibre, for 1" to 2" versions of nickel-plated CW617N UNI EN 12165

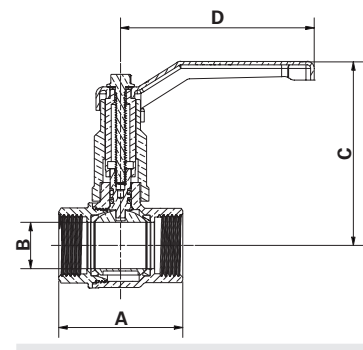
ACQUA POTABILE
DRINKING WATER



Attacchi Connections	Codice prodotto Product code		PN	A ±1mm	B mm	C mm	D mm	Conf. num. pezzi Pack. num. pieces
								
1/2"	370D1/2G1RFM	370D1/2G1BFM	25	44,5	15	76,2	83	40
3/4"	370E3/4G1RF	370E3/4G1BF	25	53	20	79,2	83	30
1"	370F001G1RF	370F001G1BF	25	66	25	104	90	30
1" 1/4	370G11/4G1RF	370G11/4G1BF	25	75	32	109	90	20
1" 1/2	370H11/2G1RF	370H11/2G1BF	25	84	40	131	160	16
2"	370I002G1RF	370I002G1BF	25	93	45	136	160	10



Con prolunga e farfalla in alluminio "T"
With extension stem and aluminium "T" handle

Per versioni 1/2" e 3/4" canotto prolunga in plastica PA6 caricata 50% fibra di vetro, per versioni da 1" a 1" 1/4 in CW617N UNI EN 12165 nichelato

For 1/2" and 3/4" versions extension made of plastic sleeve PA6 loaded 50% glass fibre, for 1" to 1" 1/4 versions of nickel-plated CW617N UNI EN 12165

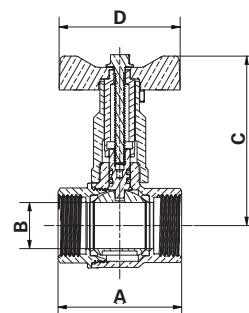

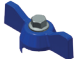
Attacchi Connections	Codice prodotto Product code		PN	A ±1mm	B mm	C mm	D mm	Conf. num. pezzi Pack. num. pieces
								
1/2"	370D1/2G6RFM	370D1/2G6BFM	25	44,5	15	70	52	10/120
3/4"	370E3/4G6RF	370E3/4G6BF	25	53	20	73	52	8/96
1"	370F001G6RF	370F001G6BF	25	66	25	88	65	4/48
1" 1/4"	370G11/4G6RF	370G11/4G6BF	25	75	32	93	65	15





Con prolunga e manopola in alluminio
With extension stem and aluminium knob

Per versioni 1/2" e 3/4" canotto prolunga in plastica PA6 caricata 50% fibra di vetro, per versioni da 1" a 1" 1/4 in CW617N UNI EN 12165 nichelato

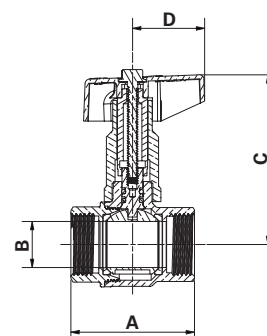
For 1/2" and 3/4" versions extension made of plastic sleeve PA6 loaded 50% glass fibre, for 1" to 1" 1/4 versions of nickel-plated CW617N UNI EN 12165



Attacchi Connections	Codice prodotto Product code		PN	A ±1mm	B mm	C mm	D mm	Conf. num. pezzi Pack. num. pieces
								
1/2"	370D1/2G2RFM	370D1/2G2BFM	25	44,5	15	70	31,5	40
3/4"	370E3/4G2RF	370E3/4G2BF	25	53	20	73	31,5	30
1"	370F001G2RF	370F001G2BF	25	66	25	90	42,5	30
1" 1/4"	370G11/4G2RF	370G11/4G2BF	25	75	32	95,5	42,5	20