

# 302



## Valvole a sfera maschio/femmina con premi-stoppa in PTFE e O-ring Male/female ball valves with PTFE seal and O-ring



**PASSAGGIO TOTALE**  
FULL BORE

**PN25**



**NICHELATE**  
**ESTERNAMENTE**  
EXTERNALLY  
NICKEL-PLATED

Per impianti idrotermosanitari, adatte al consumo di acqua potabile. Installazione in impianti di media pressione di riscaldamento industriale, civile, impianti pneumatici, per fluidi non aggressivi.

For plumbing-heating systems and drinking water consumption. Installation in medium pressure industrial and civil heating systems, pneumatic systems and for non-aggressive fluids.

Pressione di esercizio: 25 bar

Temperatura di esercizio: -20°C +130°C (gelo escluso)

Filetti cilindrici secondo norma ISO 228-1

Tenuta sull'asta:

- 3/8" asta assemblata dall'esterno con premistoppa in PTFE e regolabile con ghiera;
- da 1/2" a 2" asta assemblata dall'interno con 1 OR in EPDM PEROX, premistoppa in PTFE e regolabile con ghiera

Tenuta sulla sfera con 2 sedi in PTFE

Passaggio totale

Working pressure: 25 bar

Working temperature: -20°C +130°C (no frost)

Cylindrical threads according to ISO 228-1

Seal on stem:

- 3/8" stem assembled from outside with PTFE seal and adjustable packing gland;
- from 1/2" to 2" stem assembled from inside with 1 EPDM PEROX OR, PTFE seal and adjustable packing gland.

Seal on the ball with 2 PTFE gaskets

Full bore

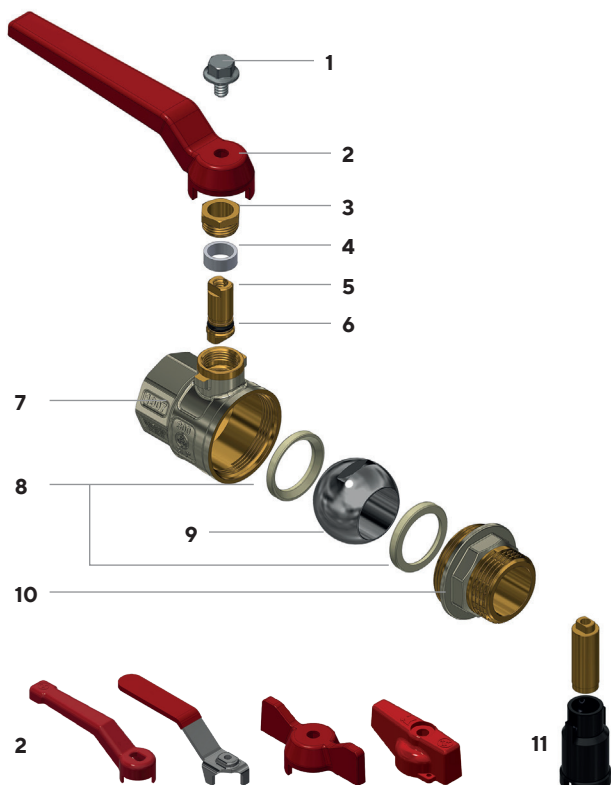

- 1 Vite in acciaio AISI 430 o in Fe-Zn/Bn a seconda dei modelli
- 2 Leve disponibili: vedi tabelle seguenti
- 3 Ghiera in CW614N UNI EN 12164
- 4 Anello premistoppa in PTFE
- 5 Asta in CW614N UNI EN 12164
- 6 O-ring in EPDM PEROX
- 7 Corpo CW617N EN 12165 nichelato solo sulla superficie esterna
- 8 Sede di tenuta in PTFE
- 9 Sfera in CW617N EN 12165 cromata
- 10 Manicotto in CW617N EN 12165 nichelato solo sulla superficie esterna
- 11 Per versioni 1/2" e 3/4" canotto prolunga in plastica PA6 caricata 50% fibra di vetro, per versioni da 1" a 2" in CW617N UNI EN 12165 nichelato



- 1 AISI 430 steel or Fe-Zn/Bn screw, depending on model
- 2 Available levers: see following tables
- 3 CW614N UNI EN 12164 packing gland
- 4 PTFE ring seal
- 5 CW614N UNI EN 12164 stem
- 6 EPDM PEROX O-ring
- 7 CW617N UNI EN 12165 body, nickel-plated on the external surface
- 8 PTFE gasket
- 9 CW617N UNI EN 12165 chrome-plated ball
- 10 CW617N UNI EN 12165 end adaptor, nickel-plated on the external surface
- 11 For 1/2" and 3/4" versions extension made of plastic sleeve PA6 loaded 50% glass fibre, for 1" to 2" versions of nickel-plated CW617N UNI EN 12165

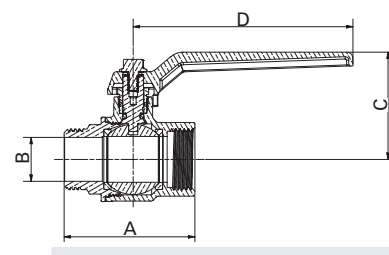

**Con leva in alluminio**  
With aluminium lever

ACQUA POTABILE  
DRINKING WATER





Attacchi Connections	Codice prodotto Product code		PN	A ±1mm	B mm	C mm	D mm	Conf. num. pezzi Pack. num. pieces
								
3/8"	302C38G5R	302C38G5B	25	48	11	41	95	12/144
1/2"	302D12G5R	302D12G5B	25	51	15	43	95	10/120
3/4"	302E34G5R	302E34G5B	25	56,5	20	46,3	95	8/96
1"	302F001G5R	302F001G5B	25	68,5	25	61,5	115	4/48
1" 1/4	302G114G5R	302G114G5B	25	77,5	32	66,7	115	15
1" 1/2	302H112G5R	302H112G5B	25	86,5	40	80,2	165	10
2"	302I002G5R	302I002G5B	25	113,6	50	88,7	165	10

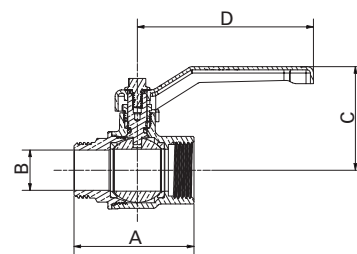

**Con leva in acciaio imbutita**  
With drawn steel lever

ACQUA POTABILE  
DRINKING WATER





Attacchi Connections	Codice prodotto Product code		PN	A ±1mm	B mm	C mm	D mm	Conf. num. pezzi Pack. num. pieces
								
3/8"	302C38G1R	302C38G1B	25	48	11	44	83	12/144
1/2"	302D12G1R	302D12G1B	25	51	15	45	83	10/120
3/4"	302E34G1R	302E34G1B	25	56,5	20	48	83	8/96
1"	302F001G1R	302F001G1B	25	68,5	25	68	90	4/48
1" 1/4	302G114G1R	302G114G1B	25	77,5	32	73	90	15
1" 1/2	302H112G1R	302H112G1B	25	86,5	40	78	160	10
2"	302I002G1R	302I002G1B	25	113,6	50	90	160	10

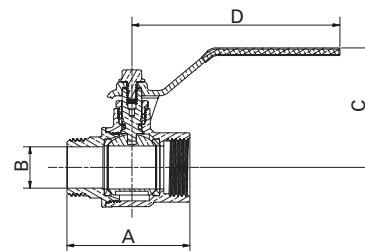

**Con leva piatta in acciaio INOX AISI 304**  
**With AISI 304 stainless steel flat lever**

 **ACQUA POTABILE**  
**DRINKING WATER**



Attacchi Connections	Codice prodotto Product code		PN	A ±1mm	B mm	C mm	D mm	Conf. num. pezzi Pack. num. pieces
								
3/8"	302C38G4R	302C38G4B	25	48	11	41	95	12/144
1/2"	302D12G4R	302D12G4B	25	51	15	43,1	95	12/144
3/4"	302E34G4R	302E34G4B	25	56,5	20	46,3	95	8/96
1"	302F001G4R	302F001G4B	25	68,5	25	59,6	115	3/36
1" 1/4	302G114G4R	302G114G4B	25	77,5	32	64,7	115	15
1" 1/2	302H112G4R	302H112G4B	25	86,5	40	77,7	165	10
2"	302I002G4R	302I002G4B	25	113,6	50	85,7	165	10



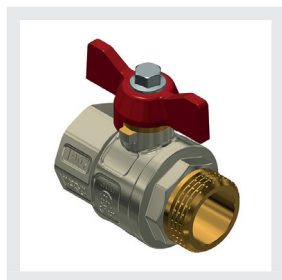

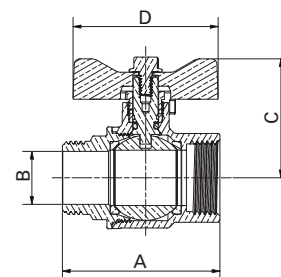

**Con farfalla in alluminio "T"**  
With aluminium "T" handle

ACQUA POTABILE  
DRINKING WATER



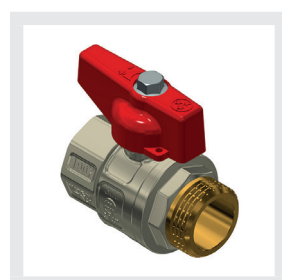

Attacchi Connections	Codice prodotto Product code		PN	A ±1mm	B mm	C mm	D mm	Conf. num. pezzi Pack. num. pieces
								
3/8"	302C38G6R	302C38G6B	25	48	11	37,5	52	12/144
1/2"	302D12G6R	302D12G6B	25	51	15	39,5	52	10/120
3/4"	302E34G6R	302E34G6B	25	56,5	20	42,5	52	8/96
1"	302F001G6R	302F001G6B	25	68,5	25	50,5	65	4/48
1"1/4"	302G114G6R	302G114G6B	25	77,5	32	55,7	65	15

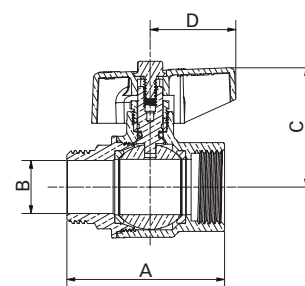

**Con manopola in alluminio**  
With aluminium knob

ACQUA POTABILE  
DRINKING WATER



Attacchi Connections	Codice prodotto Product code		PN	A ±1mm	B mm	C mm	D mm	Conf. num. pezzi Pack. num. pieces
								
3/8"	302C38G2R	302C38G2B	25	48	11	36	31,5	12/144
1/2"	302D12G2R	302D12G2B	25	51	15	39,5	31,5	10/120
3/4"	302E34G2R	302E34G2B	25	56,5	20	42,8	31,5	8/96
1"	302F001G2R	302F001G2B	25	68,5	25	53	42,5	4/48
1"1/4"	302G114G2R	302G114G2B	25	77,5	32	58,5	42,5	15





## Con prolunga e leva in alluminio With extension stem and aluminium lever

Per versioni 1/2" e 3/4" canotto prolunga in plastica PA6 caricata 50% fibra di vetro, per versioni da 1" a 2" in CW617N UNI EN 12165 nichelato  
For 1/2" and 3/4" versions extension made of plastic sleeve PA6 loaded 50% glass fibre, for 1" to 2" versions of nickel-plated CW617N UNI EN 12165

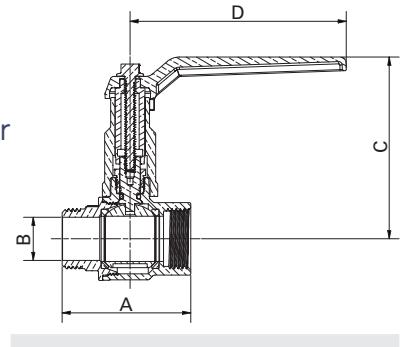
ACQUA POTABILE  
DRINKING WATER



Attacchi Connections	Codice prodotto Product code		PN	A ±1mm	B mm	C mm	D mm	Conf. num. pezzi Pack. num. pieces
								
1/2"	302D12G5RFM	302D12G5BFM	25	51	15	76,6	95	40
3/4"	302E34G5RF	302E34G5BF	25	56,5	20	79,9	95	30
1"	302F001G5RF	302F001G5BF	25	68,5	25	99	115	30
1" 1/4	302G114G5RF	302G114G5BF	25	77,5	32	104	115	20
1" 1/2	302H112G5RF	302H112G5BF	25	86,5	40	132,7	165	16
2"	302I002G5RF	302I002G5BF	25	113,6	50	140,7	165	10





## Con prolunga e leva in acciaio imbutita With extension stem and drawn steel lever

Per versioni 1/2" e 3/4" canotto prolunga in plastica PA6 caricata 50% fibra di vetro, per versioni da 1" a 2" in CW617N UNI EN 12165 nichelato  
For 1/2" and 3/4" versions extension made of plastic sleeve PA6 loaded 50% glass fibre, for 1" to 2" versions of nickel-plated CW617N UNI EN 12165

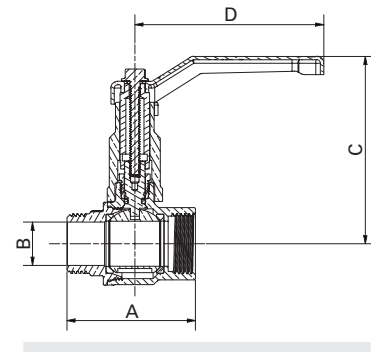
ACQUA POTABILE  
DRINKING WATER



Attacchi Connections	Codice prodotto Product code		PN	A ±1mm	B mm	C mm	D mm	Conf. num. pezzi Pack. num. pieces
								
1/2"	302D12G1RFM	302D12G1BFM	25	51	15	79	83	40
3/4"	302E34G1RF	302E34G1BF	25	56,5	20	82,3	83	30
1"	302F001G1RF	302F001G1BF	25	68,5	25	104,1	90	30
1" 1/4	302G114G1RF	302G114G1BF	25	77,5	32	109,2	90	20
1" 1/2	302H112G1RF	302H112G1BF	25	86,5	40	135,2	160	16
2"	302I002G1RF	302I002G1BF	25	113,6	50	143,2	160	10



**Con prolunga e farfalla in alluminio "T"**  
**With extension stem and aluminium "T" handle**

Per versioni 1/2" e 3/4" canotto prolunga in plastica PA6 caricata 50% fibra di vetro, per versioni da 1" a 1" 1/4 in CW617N UNI EN 12165 nichelato

For 1/2" and 3/4" versions extension made of plastic sleeve PA6 loaded 50% glass fibre, for 1" to 1" 1/4 versions of nickel-plated CW617N UNI EN 12165

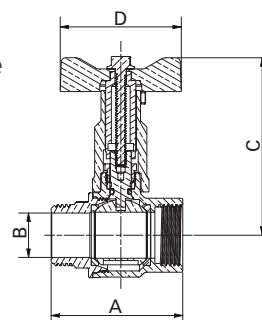

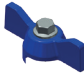
Attacchi Connections	Codice prodotto Product code		PN	A ±1mm	B mm	C mm	D mm	Conf. num. pezzi Pack. num. pieces
								
1/2"	302D12G6RFM	302D12G6BFM	25	51	15	72,9	52	40
3/4"	302E34G6RF	302E34G6BF	25	56,5	20	76,2	52	30
1"	302F001G6RF	302F001G6BF	25	68,5	25	88	65	30
1" 1/4"	302G114G6RF	302G114G6BF	25	77,5	32	93	65	20

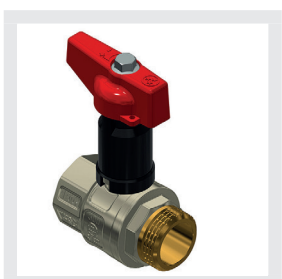



**Con prolunga e manopola in alluminio**  
**With extension stem and aluminium knob**

Per versioni 1/2" e 3/4" canotto prolunga in plastica PA6 caricata 50% fibra di vetro, per versioni da 1" a 1" 1/4 in CW617N UNI EN 12165 nichelato

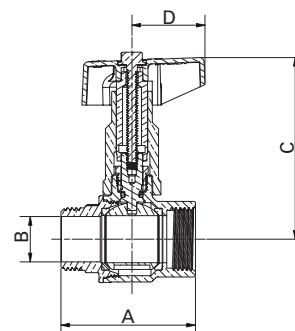
For 1/2" and 3/4" versions extension made of plastic sleeve PA6 loaded 50% glass fibre, for 1" to 1" 1/4 versions of nickel-plated CW617N UNI EN 12165



Attacchi Connections	Codice prodotto Product code		PN	A ±1mm	B mm	C mm	D mm	Conf. num. pezzi Pack. num. pieces
								
1/2"	302D12G2RFM	302D12G2BFM	25	51	15	73	31,5	40
3/4"	302E34G2RF	302E34G2BF	25	56,5	20	76,3	31,5	30
1"	302F001G2RF	302F001G2BF	25	68,5	25	90,2	42,5	30
1" 1/4"	302G114G2RF	302G114G2BF	25	77,5	32	95,3	42,5	20